



# Magnetic Lights

Magnetic Lights

www.shoaco.com



10W



25W

SH-MT10-2M SH-MT25-2M

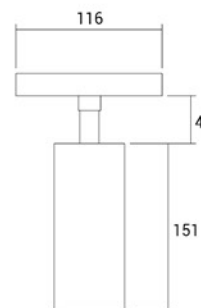
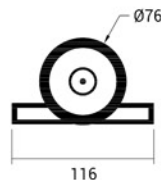
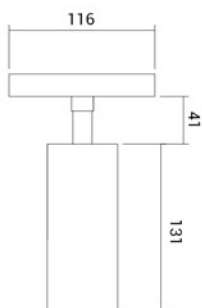
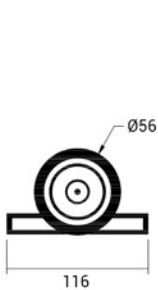

- OSRAM LED
- 48V
- CRI > 90
- 80 LUMENS
- IP20
- Cool White 4000K
- 24°
- 50,000h

# SPOT LIGHT.

SH-MT10-2M  
SH-MT25-2M



## Description چراغ‌های موضعی مگنتی

برای نورپردازی تاکیدی مانند نورپردازی یک تابلو یا نورپردازی یک جسم ۳ بعدی چراغ‌های موضعی (SpotLight) پیشنهاد می‌شود.

## Dimmension

SH-MT10-2M

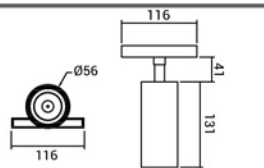

SH-MT25-2M

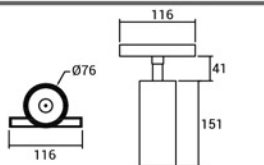

## Technical Data

Code of Product	SH-MT10-2M / SH-MT25-2M
Power	10 Watt / 25 Watt
Beam Angle	24 Degree
Color Temperature	4000 K
Light Efficiency	80 Lumen / Watt
Color Rendering Index	> 90
Operating Temperature	-20 ~ +50
Rated Life Hours	35000-50000 Hours
COB By	COB By 